



TOOL CHANGE ORDER

RIVIAN	TOOL NUMBER	TSN01447-900-B
	TITLE	GL TECHNICS EBS-100
	REV - DATE	REV 2 - 4/17/2026

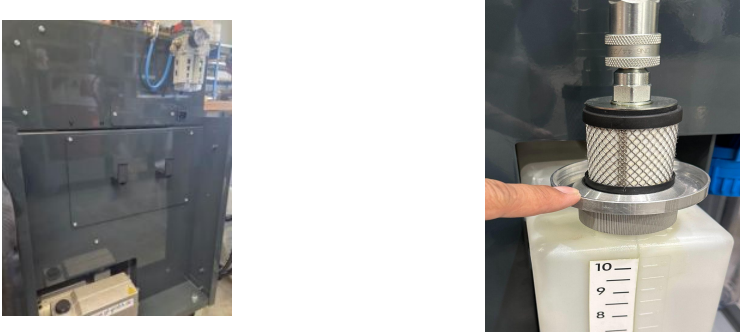

BACKGROUND

An additional waste buffer tank has been added to the GL Technics EBS-100 to improve drain tank performance and prevent ruptures.

An update to vent valve to improve reliability

PREVIOUS COMPONENT	UPGRADED COMPONENT
	

COMPONENTS TO BE CHANGED : Vent Valve

PREVIOUS COMPONENT	UPGRADED COMPONENT
	

Waste Tank upgrade kit

GL-400.509.023 | Buffer Storage Assembly

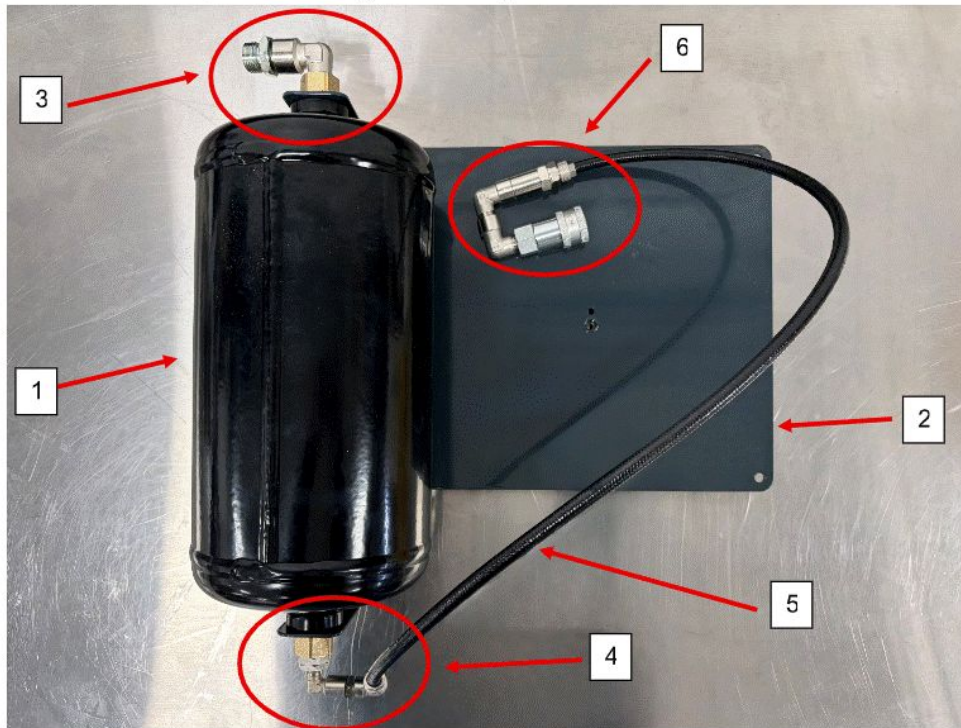

ITEM	QTY	GL P/N	DESCRIPTION
1	1	GL-400.509.023.1	Buffer tank
2	1	GL-400.509.023.2	Rear Plate
3	1	GL-400.509.023.3	Fittings for input of buffer tank
4	1	GL-400.509.023.4	Fittings for output of buffer tank
5	1	GL-400.509.023.5	Hose between buffer tank and coupler
6	1	GL-400.509.023.6	Coupler assembly to waste tank

Vent Valve update

GL-400.509.022 | Ventilation Valve Assembly Optimization

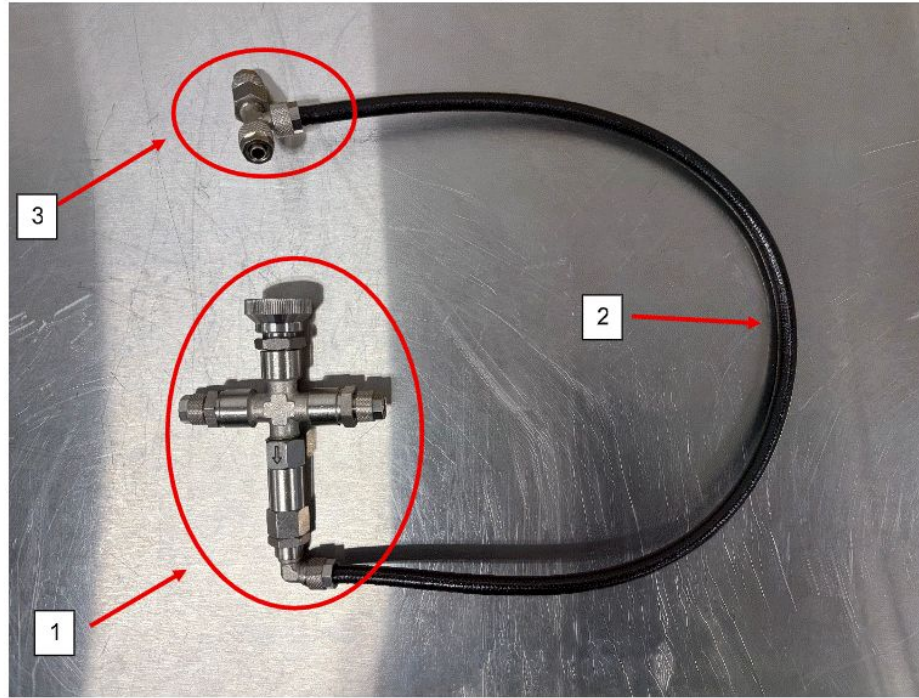

ITEM	QTY	GL P/N	DESCRIPTION
1	1	GL-400.509.022.1	Vent Valve V2
2	1	GL-400.509.022.2	Hose between vent valve + T- Fitting
3	1	GL-400.509.022.3	T- Fitting

NOTE: When performing the update, **START** with the venting valve, then the waste tank.

Step-by-step guide how to update your EBS100R: Updating the venting valve

Step 1: Watch the video to see how to remove the control unit



Step 2: Identify the version of your EBS100R. There are two different versions of the EBS100R.

Important: Check if the hose marked with the red arrow is missing or not.

If your device contains this hose, follow the instructions in **purple**. If the hose is missing, follow the steps colored in **orange**.

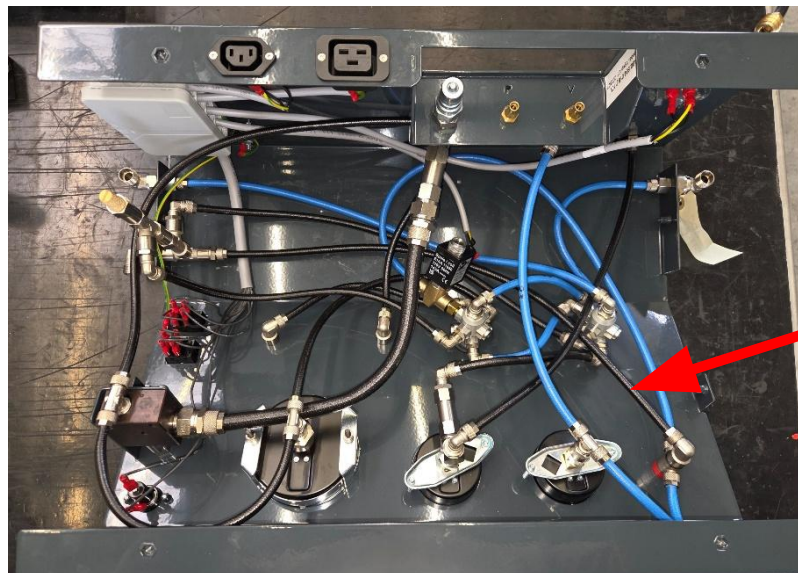

Step 3: Unscrew the 2 hoses of the old venting valve with a wrench metric size 12

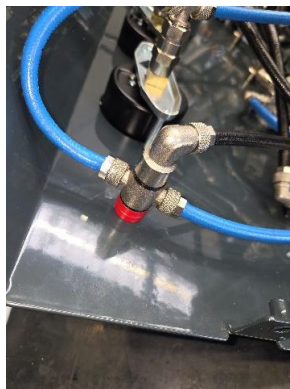

Step 3: Unscrew the 3 hoses of the old venting valve with a wrench metric size 12



Step 4: Unscrew the old venting valve with wrenches in metric size 17 and 19

Step 4: Unscrew the old venting valve with wrenches in metric size 13 and 19



Stick the two threaded pieces through the hole in the sheet (BLUE frame)

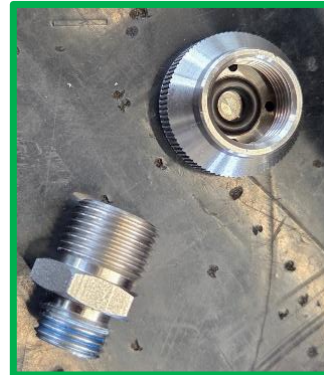

Step 5: Install the new venting valve by unscrewing the two parts in the GREEN frame by hand to separate it from the crosspiece.

Add some medium loctite on the thread which reaches inside the control unit (GREY frame)



Then adjust the crosspiece on this part (RED frame)

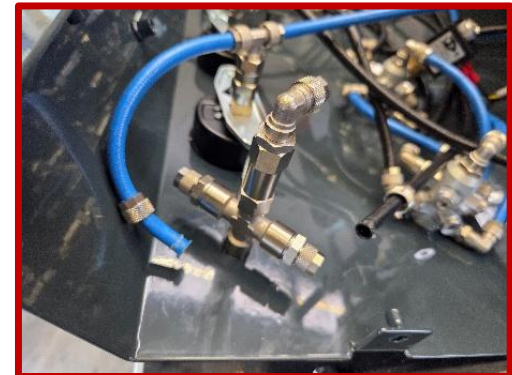

Step 6: Attach the 2 unscrewed hoses from step 3 to the new venting valve.

Step 6: Attach the 3 unscrewed hoses from step 3 to the new venting valve.

You will not need the black hose and the T-piece of your new assembly.

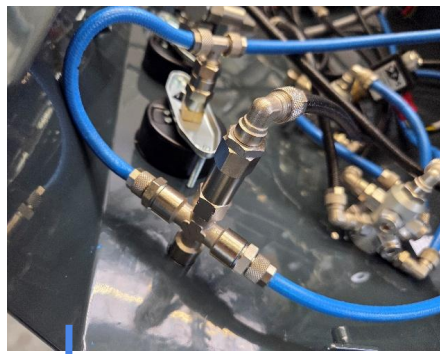

IF APPLICABLE

NOTE: You may need to re-route the vent valve line (shown in **Yellow**) to prevent any kinks and ensure there is sufficient length in the line



T-Piece (Early build internal vent design)

If the hose marked with the **red** arrow (step 2) is missing, cut out 1 inch of the hose marked with the **Yellow** arrow and install the T-piece of the new assembly (see picture with **Yellow** frame). Connect line shown in **RED** to the venting valve

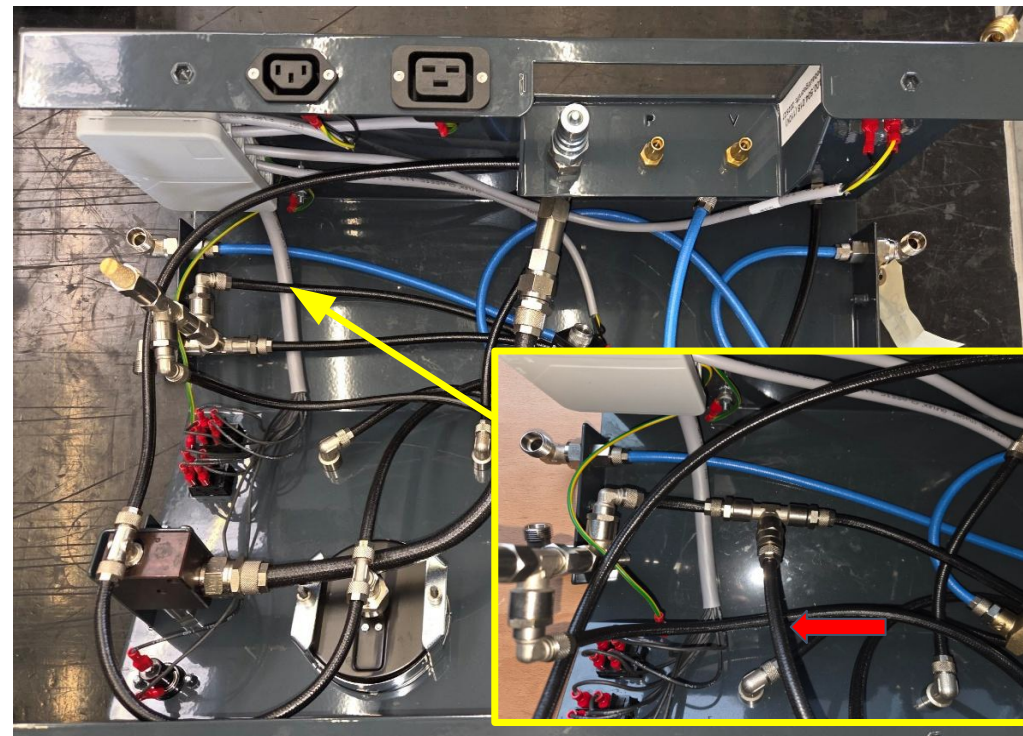
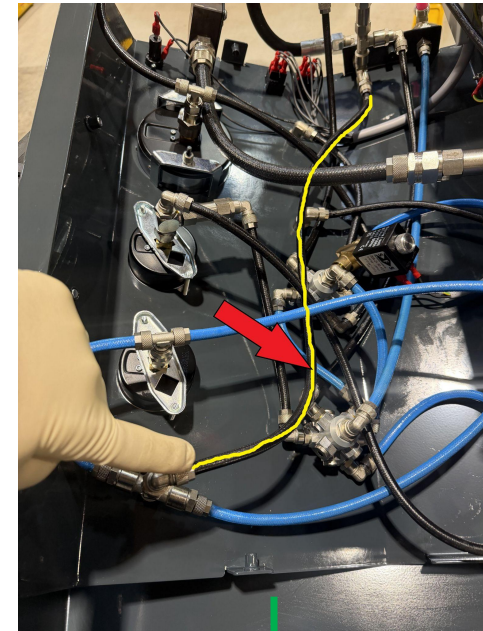

Step 7: Screw the cap of the venting valve on the thread and attach the control unit back to the device.



Step-by-step guide how to update your EBS100R: Attach the buffering tank



Step 1: Remove the power cord, then remove one of the black brackets with an allen key metric size 5 and save it for later, remove the back plate with an allen key metric size 4 and save the four screws for later.

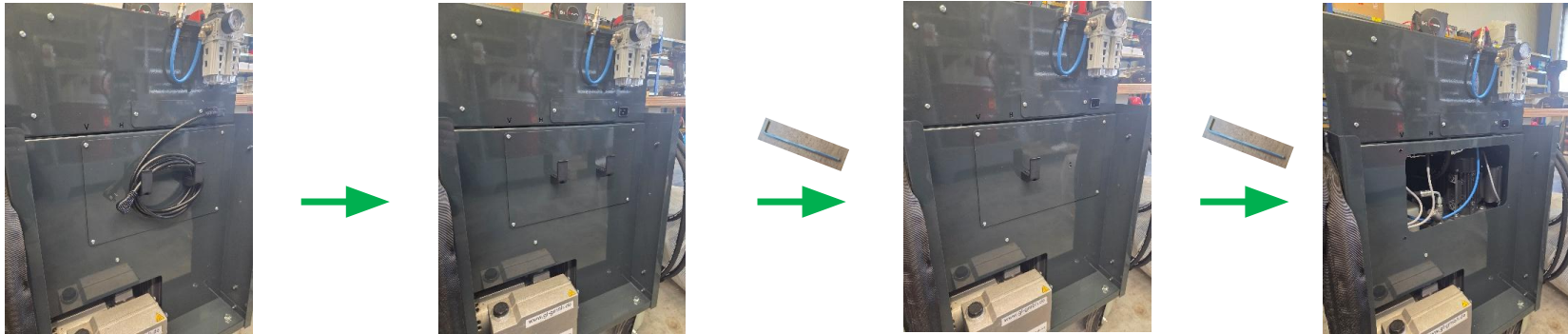

Step 2: Attach the new assembly with the saved screws of step 1 and an allen key metric size 4. Stick the hose through the open housing and catch it in the front after taking the waste oil tank out of the housing.

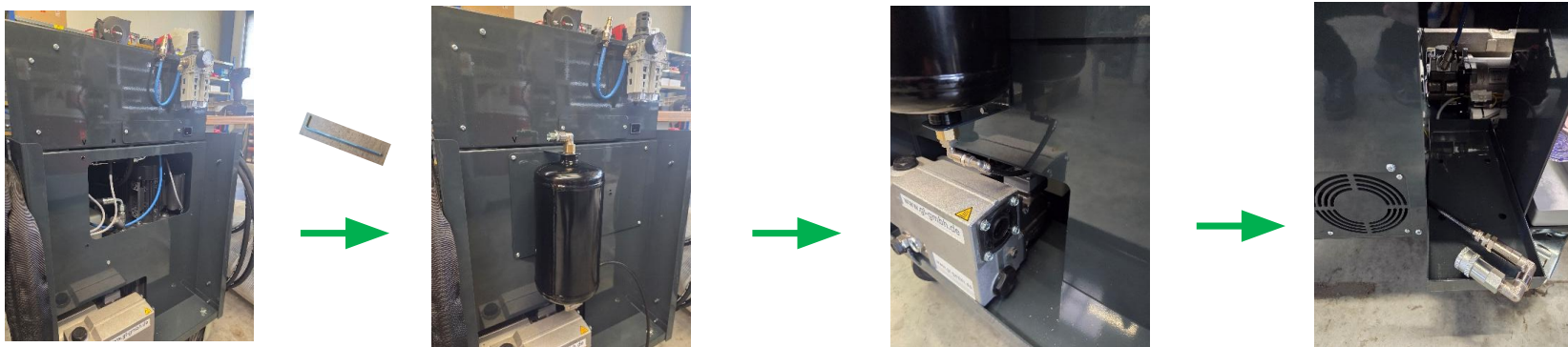

Step 3: Uncouple the coupling from the tank in the front and remove the coupling and the threaded piece shown in the picture with the red frame with wrenches in metric sizes 19 and 22 . You can save them as a spare part. Attention: Some oil can drop out of the open hose. Use a wipe.



Step 4: Put the waste oil tank back in the housing and connect the coupling of the new assembly with the coupling of the waste oil tank. Connect the open hose with the new assembly as you can see it in the picture with the purple frame. Use a wrench metric size 22. Attach the saved black bracket with an allen key metric size 5 and attach the power cord.

