

TOOL USE INSTRUCTION

RIVIAN	TOOL NUMBER	TSN01601-300-A
	TITLE	BATTERY SHOULDER BOLT, EDV
	REV - DATE	REV A - 5/1/2025

CONTENTS

[SAFETY](#)

[INITIAL SETUP](#)

[TOOL USE INSTRUCTION](#)

[MAINTENANCE & STORAGE](#)

[SYMBOL GLOSSARY](#)

TOOL FUNCTION

USED TO PARTIALLY LOWER THE HV BATTERY TO GAIN ACCESS DURING EDV-500 REMORA RETROFITS

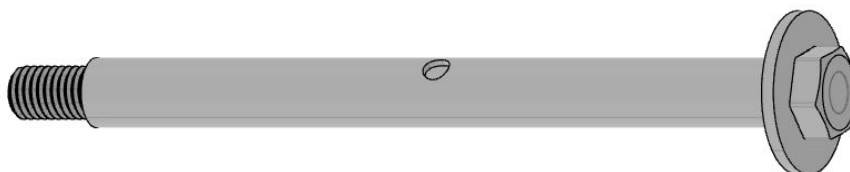

SPECIFICATIONS

Weight: 0.3 kg (0.7 lbs) per bolt

Overall Dimensions: \varnothing 15.875 x 208 mm (Flange \varnothing 37mm)

Thread Size: M12 x 1.75

Load Rating: 1,134 kg (2500 lbs) for set of 8

LABOR CODES

183261018 - Axle/Leaf Spring/Frame Assembly

OTHER TOOLS REQUIRED

TSN01603-300-A - REMORA EDV LIFT TABLE SUPPORT JIG

TSN00486-10X - BATTERY LIFT TABLE





WARNING

Do not perform procedure if tool is damaged or missing parts. Consult the Rivian Service Tool Catalog for replacement components.

Failure to follow guidelines outlined in this document could result in injury and/or property damage.

SAFETY GUIDELINES

1	This tool is designed for use specifically for retrofitting EDV vehicles with Gen 2 rear subframes. Contact Rivian Service Tool Engineering prior to use in any other scenario.	
2	Do not exceed the listed load rating of the tool.	
3	Pinch points - keep hands and fingers clear of all moving parts when operating the tool.	

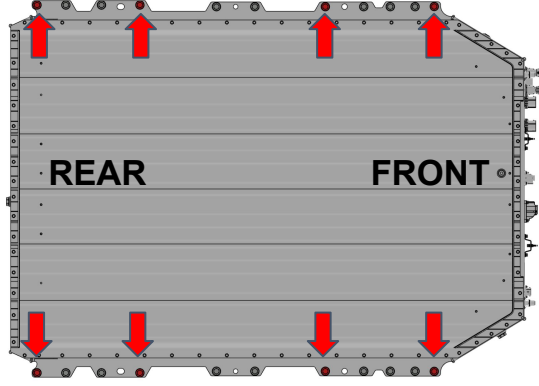
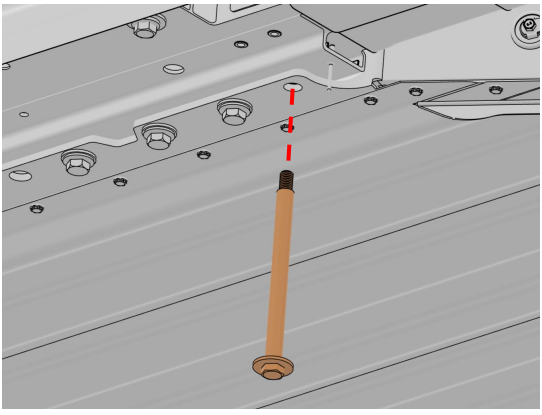
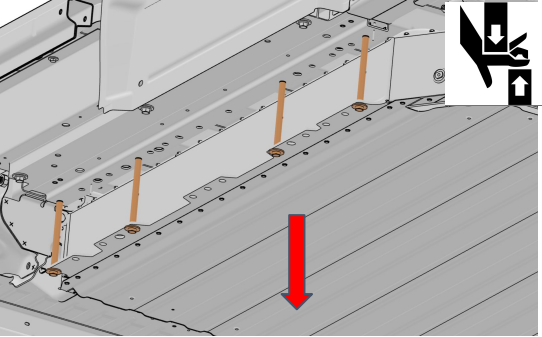

1	<p>REMORA EDV RETROFIT</p> <p>NOTE</p> <p>See Remora service procedure for detailed steps preceding lowering of the HV battery.</p>	
2	<p>With battery lift table in place and supporting the HV battery, remove 8x fasteners shown.</p>	
3	<p>Install 8x shoulder bolts until shoulder is fully seated against the vehicle frame.</p> <p>Remove remaining battery fasteners.</p> <div data-bbox="211 1136 789 1348" style="border: 1px solid black; padding: 10px; margin-top: 10px;"> <p>IMPORTANT</p> <p>Ensure shoulder of the bolt seats against frame and doesn't catch on the flange of the pack during install.</p> </div>	
4	<p>Slowly lower battery lift table until weight of pack is evenly supported by the shoulder bolts.</p> <p>Visually check that pack is level then fully remove battery lift table.</p> <p>NOTE</p> <p>Procedure is reversed for reinstalling the battery into the vehicle.</p>	



MAINTENANCE & STORAGE

TASK	FREQUENCY
Inspect bolt surfaces and threads for signs of damage, excessive wear, or debris. Clean and/or replace as needed.	Before Each Use
Store bolts as a set, indoors in a dry environment	After Each Use

SYMBOL GLOSSARY



WARNING
Risk of minor injury



CAUTION
Pinch Point - keep hands and fingers clear of all moving parts.

IMPORTANT
Instructions to successfully complete a task

NOTE
Useful information

REVISION LOG

REV	DATE	CHANGE DESCRIPTION
A	5/1/2025	Initial release

