	TOOL USE INSTRUCTION	
	Tool Number: NCT05237443	REV: 1.0
	Title: AXLE FORK SET	DEPT: Service Engineering

Author	Peter Langel	Approver(s)	
---------------	--------------	--------------------	--

Revision Log:

REV	Revision Description (Reason for Change)	Author	Rev. Date
1.0	INITIAL REVIEW	P.Langel	4/8/2021

Reference

Labor Code: 426410010 Rear Halfshafts

PURPOSE: This tool is used to pry the half shafts from the Rear Drive Unit.

GENERAL PRINCIPLES:

1. The tool set consists of a Shim and Wedge

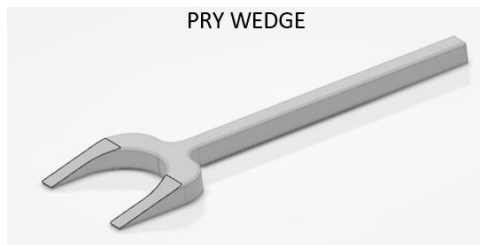

USING THE TOOL:

Rear Drive Unit

1. Insert the Shim against the Rear Drive Unit
2. Insert the Pry Wedge between the Axle and the Shim.



Important Note: Have a helper support the axle so that it is not hanging. When the axles are left to hang under their own weight, it creates binding in the inner splines, making removal difficult. The axle will come free from the drive unit much easier if it is supported.

3. Use Caution not to damage the electrical connector on the upper side of the drive unit

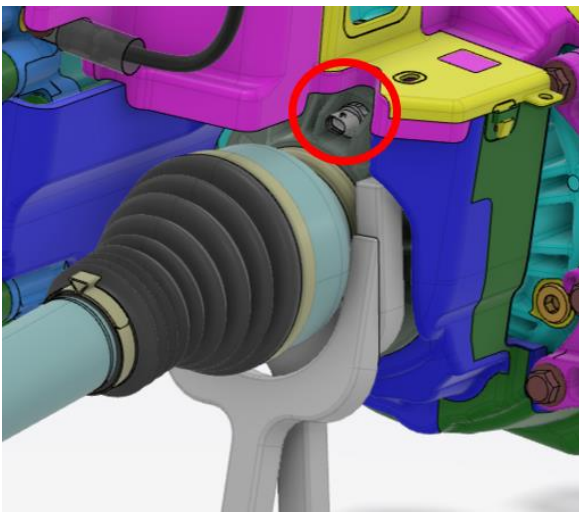

4. Pull the 2 handles together, creating a lever action at the axle, until the axle pops. This creates a lever action to extract the axle spline from the Drive Unit

Note: Be careful not to pinch your fingers when the 2 handles come together

5. Pry until the axle is completely free from the Drive Unit
6. End Instruction