

## TOOL USE INSTRUCTION

# RIVIAN

TOOL NUMBER TSN00781-300-C

TITLE KIT, DRIVE UNIT CRADLE

REV - DATE REV C - 4/21/2025

### CONTENTS

[OVERVIEW](#)

[SAFETY](#)

[INITIAL SETUP](#)

[TOOL USE INSTRUCTION](#)

[MAINTENANCE & STORAGE](#)

[SERVICE & REPLACEMENT PARTS](#)

[TROUBLESHOOTING](#)

[SYMBOL GLOSSARY](#)

### TOOL FUNCTION

THIS CRADLE IS USED TO SUPPORT THE R1 REAR ENDURO, EDV FRONT ORIGIN AND EDV FRONT ENDURO DRIVE UNITS DURING INSTALLATION/REMOVAL.

#### Origin Cradle & Adapter Plate

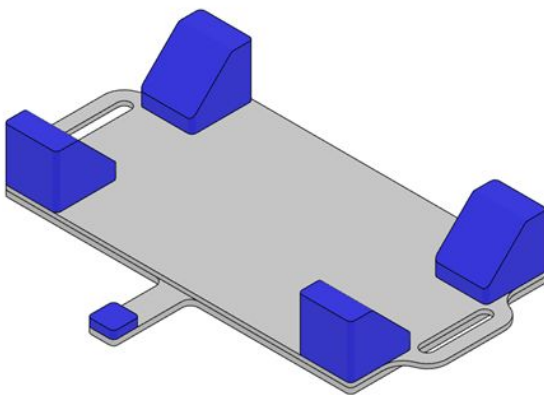

#### Enduro Cradle & Adapter Plate

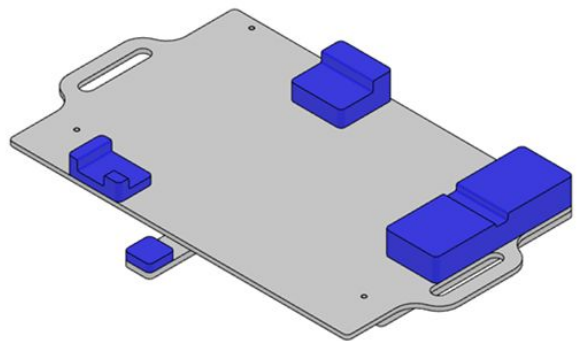

OVERVIEW

SPECIFICATIONS

Weight: 10.4 kg  
Overall Dimensions: 395 mm x 89 mm x 576 mm

LABOR CODES

465515011, Subframe, Front (Remove and Reinstall)  
381010010, Drive Unit, Front (Remove and Replace)

OTHER TOOLS REQUIRED

TSN01432-100-A | TRANSMISSION JACK - 1/2 TON CAPACITY

COMPONENT GUIDE

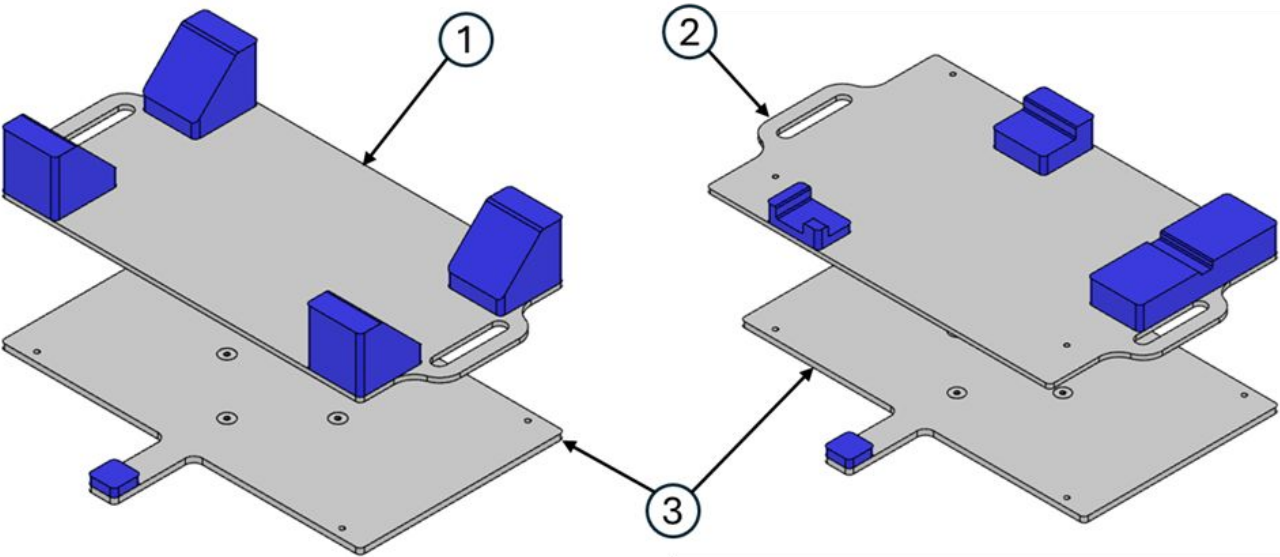

ITEM	QTY	NAME	TOOL P/N
1	1	DRIVE UNIT CRADLE, ORIGIN PLATE	TSN00781-201-B
2	1	DRIVE UNIT CRADLE, ENDURO PLATE	TSN00781-202-B
3	1	DRIVE UNIT CRADLE ADAPTER PLATE - TRANSMISSION JACK	TSN00781-203-A







**WARNING**

Do not perform procedure if tool is damaged or missing parts. Consult the Rivian Service Tool Catalog for replacement components.

Failure to follow guidelines outlined in this document could result in injury and/or property damage.

**SAFETY GUIDELINES**

1	<b>PPE Required</b> <ul style="list-style-type: none"> <li>Eye Protection, Gloves, Closed Toe Shoes</li> </ul>	
2	<b>CAUTION:</b> <ul style="list-style-type: none"> <li>Risk of damage to wire harnesses and coolant hoses when lowering the drive unit. Use a spotter to make sure all components are clear prior to raising or lowering the tool.</li> </ul>	
3	<b>PRIOR TO USAGE:</b> <ul style="list-style-type: none"> <li>Visually inspect drive unit cradle for damage prior to use.</li> <li>Operate the powertrain lift to ensure functionality. Refer to manufacturer's specifications for proper maintenance.</li> <li>Verify presence of (2x) 7/16" Dia, 3-1/2" long, quick release pins.</li> </ul>	
4	<b>CAUTION:</b> <ul style="list-style-type: none"> <li>Do not perform procedure if any equipment is missing or damaged.</li> </ul>	

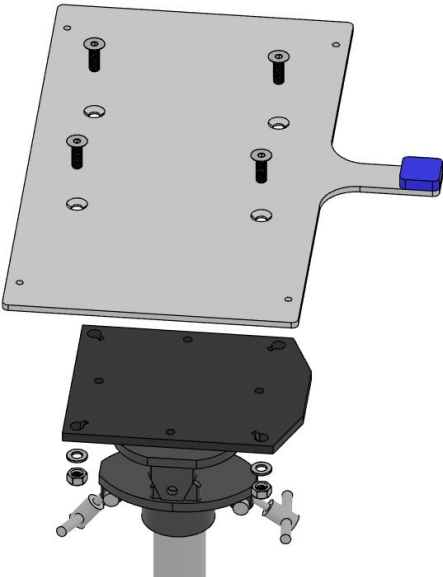

## INITIAL SETUP

Step	Directions	Visual Aid
1	Mount the Drive Unit Cradle Adapter Plate to the Universal Saddle on the Transmission Jack using the supplied hardware (4X) FHS M10 X 1.5 X 30 (4X) M10 LOCKNUT (4X) M10 WASHER	 A technical diagram illustrating the assembly of a drive unit. A light gray rectangular plate, labeled as the 'Drive Unit Cradle Adapter Plate', is shown being positioned above a dark gray 'Universal Saddle' which is mounted on a 'Transmission Jack'. The plate has four pre-drilled holes for mounting. The saddle is a hexagonal base with a central vertical post and four horizontal adjustment arms. The diagram shows the plate being lowered into place, ready to be secured with the specified hardware.

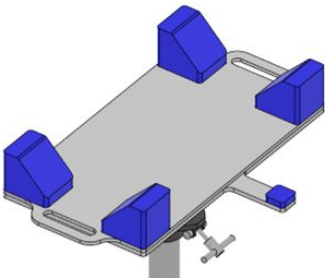
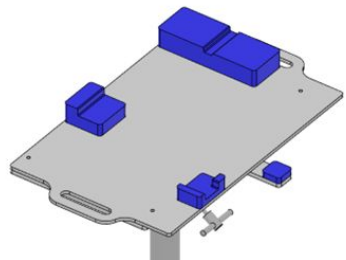
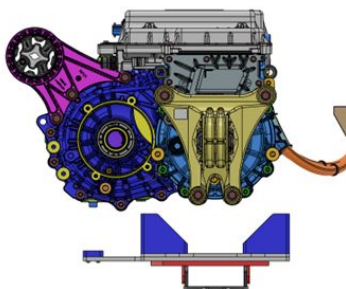
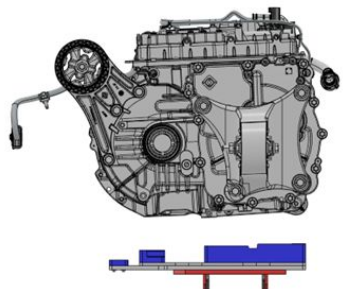

## TOOL USE INSTRUCTION

Step	Directions	Visual Aid (Origin)	Visual Aid (Enduro)
1	Ensure all 12v harnesses and coolant lines are disconnected from the drive unit. Reference the service manual for procedure, labor code 381010010.		
2	Install the correct Cradle for the appropriate DU. Verify the Cradle is sitting flush on the Adapter Plate and that all four dowels are inserted.		
3	Slowly raise the transmission jack up to the drive unit, aligning the center support with the bottom side of the gearbox housing.		

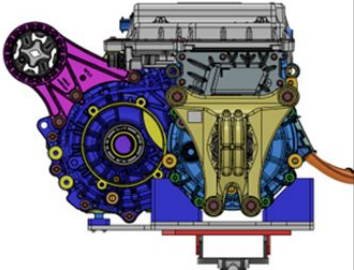
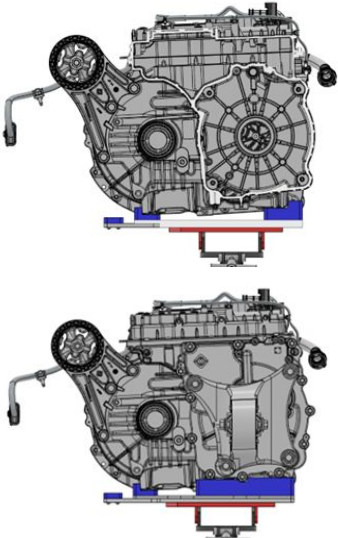

Step	Directions	Visual Aid (Origin)	Visual Aid (Enduro)
4	<p>The drive unit is properly supported when the motor housing makes contact with all of the supports</p>		
5	<p>Remove bolts attaching drive unit to EDV frame and slowly lower the DU from the vehicle.</p> <p><b>⚠ Note:</b> Always have a spotter on each side of the vehicle when lowering the drive unit to make sure all wire harnesses and coolant hoses clear the vehicle.</p>		

*Link Here (If applicable) to Tooling Maintenance Guide (TMG)*

**BASIC MAINTENANCE GUIDE**

TASK	FREQUENCY
Verify all components are accounted for	Before and after every use
Inspect all components for damage	Before and after every use





### **DANGER**

Risk of electrocution or electric shock



### **WARNING**

Risk of minor injury



### **DANGER**

Risk of major injury such as

- fire
- chemical or poison
- crushing / maiming
- death



### **CAUTION**

Risk of

- damage to vehicle or property
- data disruption
- voiding warranty

### **IMPORTANT**

Instructions to successfully complete a task

### **NOTE**

Useful information

## REVISION LOG

---

REV	DATE	CHANGE DESCRIPTION
A	8/12/2022	Initial release
B	6/20/2023	Updated Tool Use Instructions to match latest tool revision.
C	4/21/2025	Updated Tool Use Instructions to match latest tool revision.

