

TOOL USE INSTRUCTION

RIVIAN

TOOL NUMBER TSN00953-300-B

TITLE SOCKET, AIRLINE FITTING 12MM

REV - DATE REV B - 04/22/2025

CONTENTS

[OVERVIEW](#)

[SAFETY](#)

[INITIAL SETUP](#)

[TOOL USE INSTRUCTION](#)

[MAINTENANCE & STORAGE](#)

[SERVICE & REPLACEMENT PARTS](#)

[TROUBLESHOOTING](#)

[SYMBOL GLOSSARY](#)

TOOL FUNCTION

USED FOR REMOVAL AND INSTALLATION OF 12MM VOSS AIRLINE FITTING ON R1 FRONT SUSPENSION.



OVERVIEW

SPECIFICATIONS

WEIGHT: 0.047 KG

Overall Dimensions: 17.5 MM X 50.0 MM

LABOR CODES

•185433010 – LINE ASSEMBLY, AIR SPRING (REMOVE AND REPLACE)

OTHER TOOLS REQUIRED

TSN00047-100-B: 1/4" DIGITAL TORQUE WRENCH

SOCKET DIMENSIONS

| SQUARE DRIVE SIZE | SOCKET SHAPE | DRIVE SIZE | OVERALL LENGTH | OD |
|-------------------|--------------|------------|----------------|---------|
| 1/4" | 6-POINT | 12MM | 50.00MM | 17.50MM |

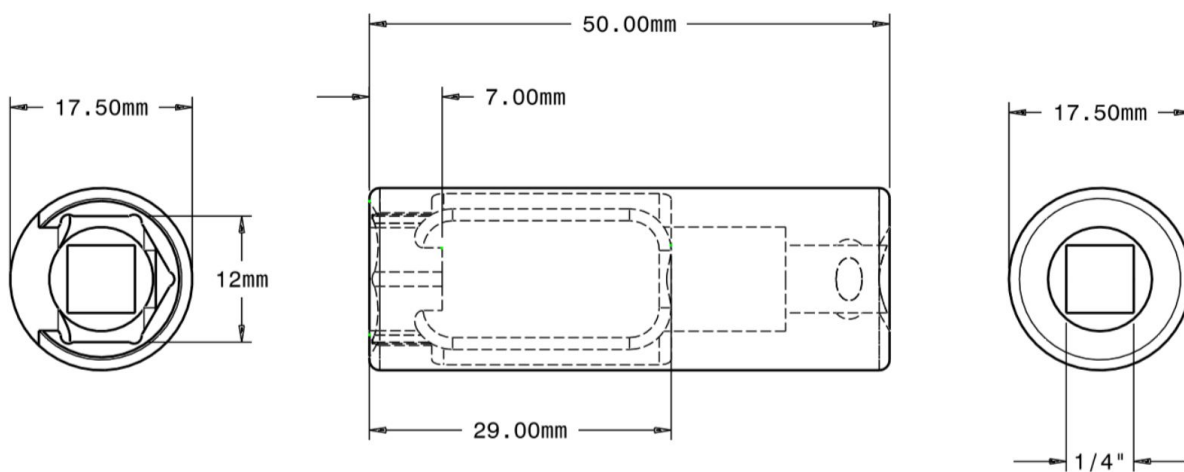

**WARNING**

Do not perform procedure if tool is damaged or missing parts. Consult the Rivian Service Tool Catalog for replacement components.

Failure to follow guidelines outlined in this document could result in injury and/or property damage.

SAFETY GUIDELINES

| | | |
|---|--|--|
| 1 | <p>Risk of major injury if:</p> <ul style="list-style-type: none">• Air suspension system isn't depressurized (up to 80 Psi)• If the airline fitting is under-torqued | |
| 2 | <p>Damage to the airline / airline fitting can occur if:</p> <ul style="list-style-type: none">• Over-torqued• Repeatedly tightened and loosened• Kinking occurs in the hose | |
| 3 | <p>PPE Required:</p> <ul style="list-style-type: none">• Ear protection• Eye protection | |

INITIAL SETUP

| | | |
|---|--|---|
| 1 | Depressurize the air suspension system using RiDE | |
| 2 | Remove necessary items to gain access to the airline fitting |  |



1

Check that the socket fits as shown.

Depending on the orientation of the airline fitting, it may need to be rotated to properly align.



2

Using the socket, extension and wrench, loosen fitting.

Once minimal force is required to turn the socket, remove fitting by hand.

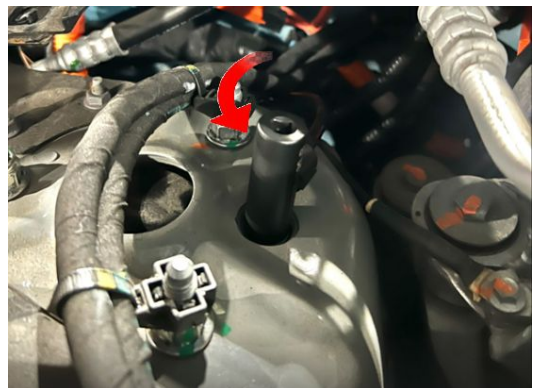

3

When ready to be installed, hand tighten the airline fitting using the socket until it's unable to be tightened further

Next, using a digital torque wrench, torque the airline fitting

Refer to the service manual for the torque specification



MAINTENANCE & STORAGE

| TASK | FREQUENCY |
|--|-------------------------------------|
| Inspect socket for damage. Do not use if socket is damaged | Prior to Each Use After Each Use |
| Return socket to its storage location | After Each Use |



TROUBLESHOOTING

| PROBLEM | SOLUTION |
|--|--|
| Socket isn't able to properly tighten/loosen the airline fitting | <p>Inspect the tool to see if the following exists:</p> <ul style="list-style-type: none">• Roundness/stripping• Wear/tear• Significant discoloration <p>If any of these issues are seen, replace the tool as needed</p> |



SYMBOL GLOSSARY



DANGER



CAUTION



CAUTION



PPE REQUIRED

REVISION LOG

| REV | DATE | CHANGE DESCRIPTION |
|-----|------------|--|
| A | 01/03/2023 | Initial release |
| B | 04/22/2025 | Updated instructions to the latest TUI template and latest revision of the tool. |

