

TOOL USE INSTRUCTION

RIVIAN

TOOL NUMBER	TSN01736-300
TITLE	OUTPUT SEAL PROTECTOR TOOL, 50MM
REV - DATE	REV 1 - 02/11/2026

CONTENTS

[OVERVIEW](#)

[SAFETY](#)

[INITIAL SETUP](#)

[TOOL USE INSTRUCTION](#)

[MAINTENANCE & STORAGE](#)

[SPARE PARTS](#)

[TROUBLESHOOTING](#)

[SYMBOL GLOSSARY](#)

TOOL FUNCTION

PROTECTS ENDURO, ASCENT, AND MAXIMUS OUTPUT SEALS DURING HALFSHAFT INSTALL.

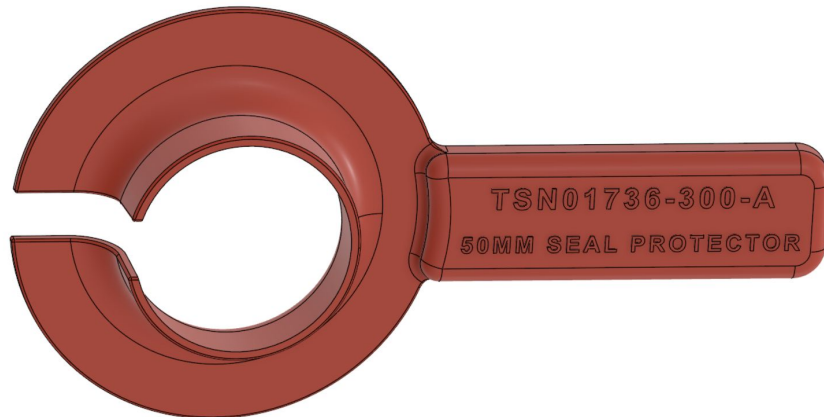

**WARNING**

Do not perform procedure if tool is damaged or missing parts. Consult the Rivian Service Tool Catalog for replacement components.

Failure to follow guidelines outlined in this document could result in injury and/or property damage.

SAFETY GUIDELINES

1	<p>PPE Required</p> <ul style="list-style-type: none"> • Damage to vehicle or property 	
2	<p>Risk of Pinch Point</p> <ul style="list-style-type: none"> • Be careful when installing halfshaft 	



SPECIFICATIONS

WEIGHT: 0.05KG

OVERALL DIMENSIONS: 90.0MM X 170.7MM

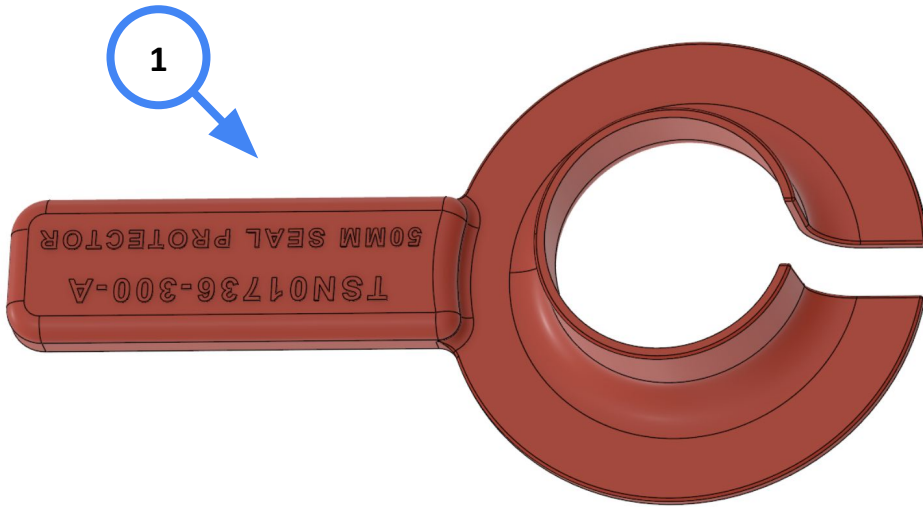

COMPONENT GUIDE

ITEM	QTY	RIVIAN TOOL ID	DESCRIPTION
1	1	PT01683903-A	OUTPUT SEAL PROTECTOR TOOL, 50MM



1

Output Seal Protector is compatible with the following drive unit configurations:

- Enduro (R1) FDU and RDU
- Ascent FDU and RDU
- Maximus FDU and RDU

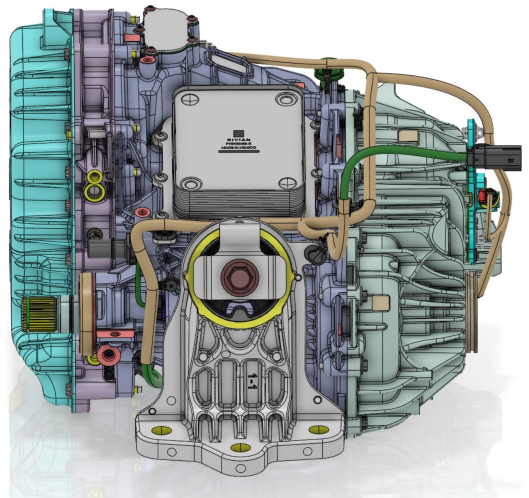
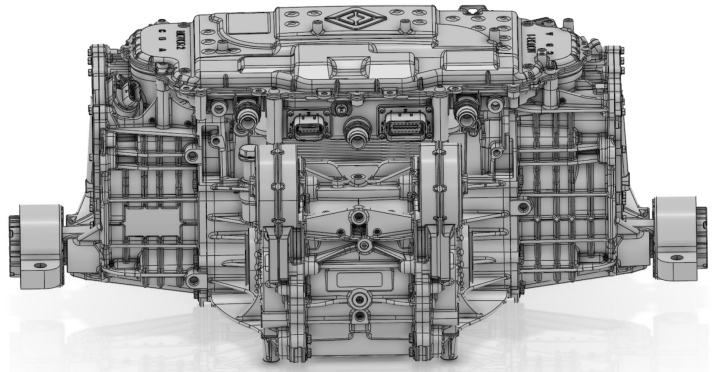
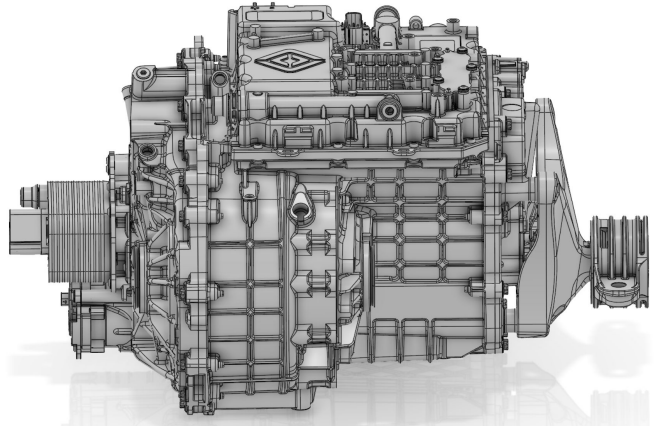

1

Attach Seal Protector to output seal as shown.

Slide it into drive unit until its larger OD fully seats to the casting.

If Seal Protector appears to lose retention, refer to the next step, otherwise move on to step 3.

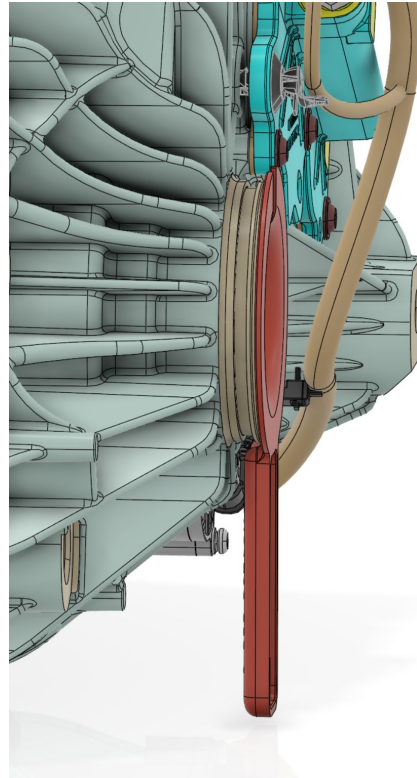
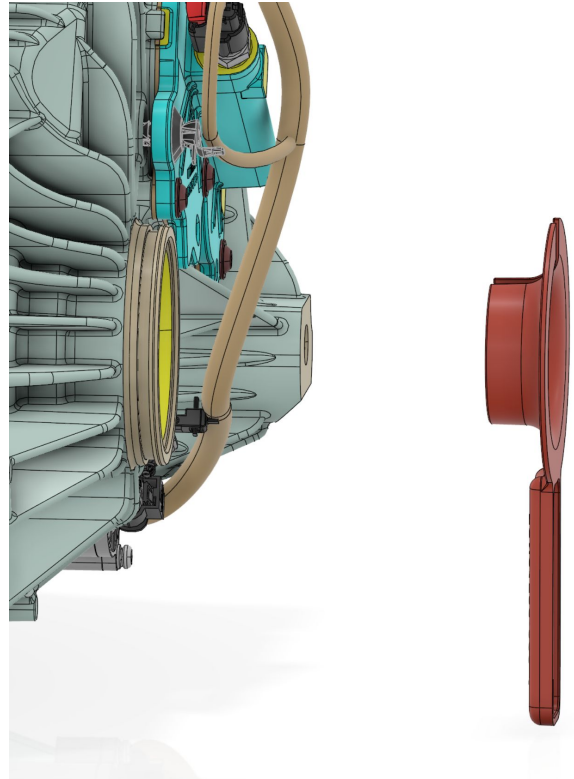

2

If experiencing issues with keeping Seal Protector retained, tuck the handle behind harnessing as shown.

Harnessing configuration may differ between Maximus, Enduro, and Ascent

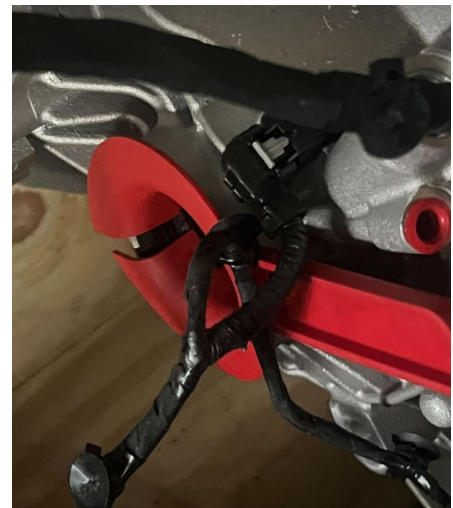
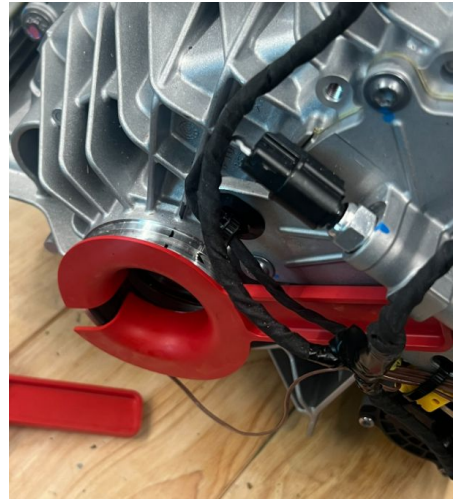

3

Begin to install Halfshaft by only sliding it in partially until axle spline engagement is felt.

Next, pull Seal Protector handle downward and detach it from the drive unit

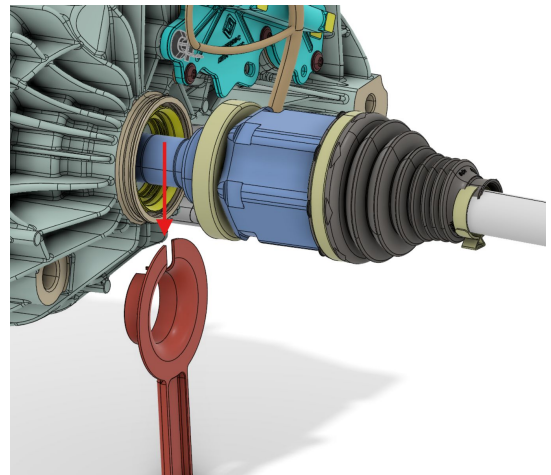
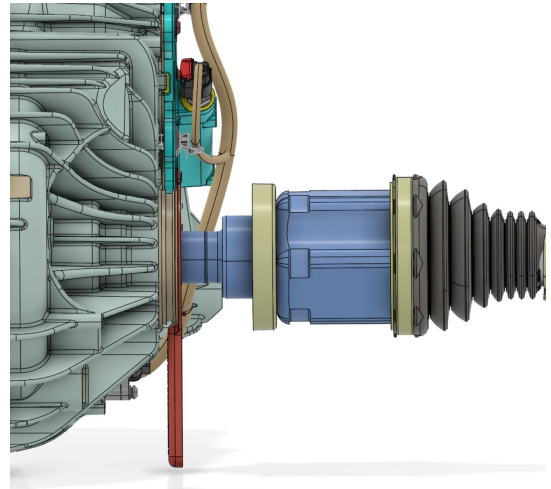
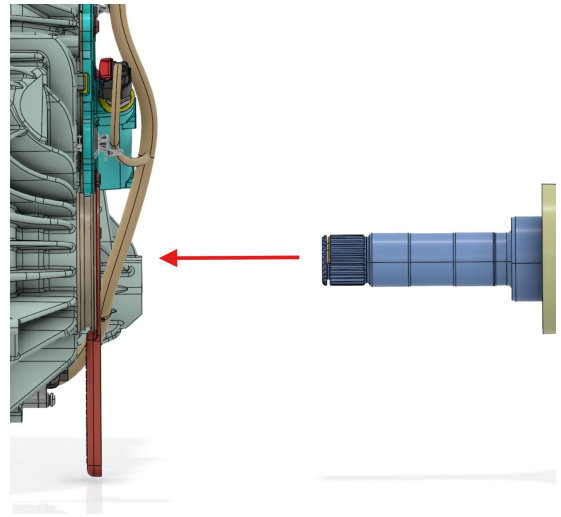

4

Completely install
Halfshaft into Drive Unit.

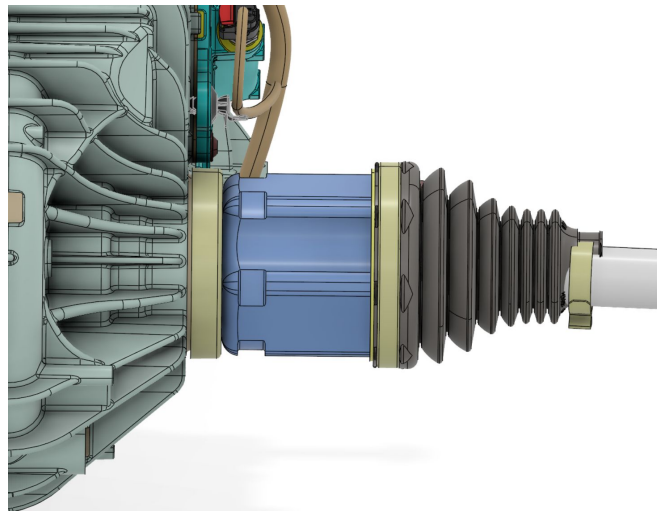
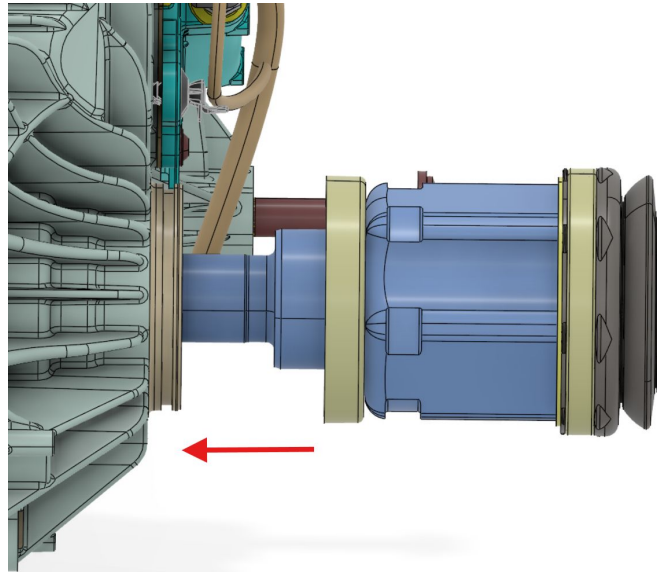

TASK	FREQUENCY
Inspect tool for damage, tears, or nicks	Before Each Use
Return tool to its storage location	After Each Use



FOR OTHER ITEMS NOT SHOWN, CONTACT RIVIAN SERVICE TOOL ENGINEERING

ITEM	DESCRIPTION	SUPPLIER + PART NUMBER
1	OUTPUT SEAL PROTECTOR TOOL, 50MM	SNAP-ON BUSINESS SOLUTIONS PN - TSN01736-300-A

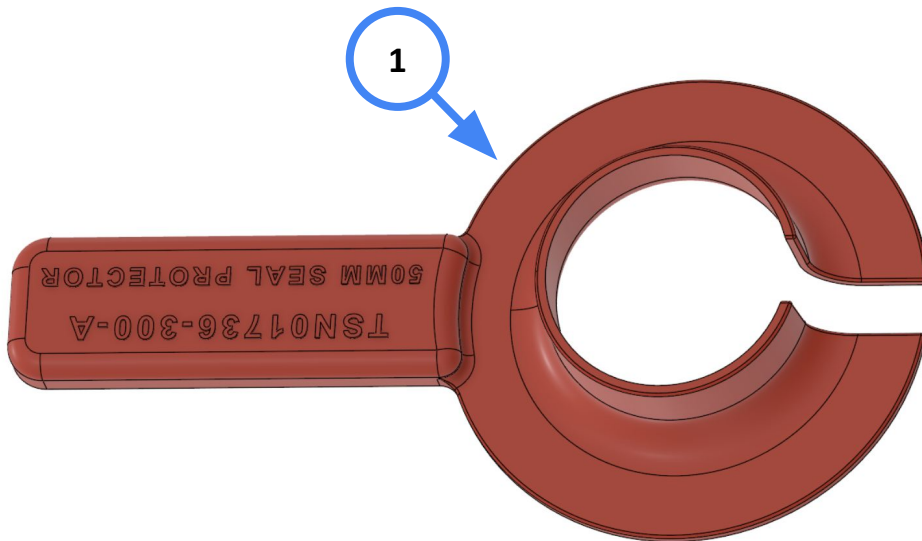

PROBLEM	SOLUTION
Seal protector either shows excessive resistance or is unable to be removed from output seal.	<ul style="list-style-type: none">● Halfshaft was installed too close and/or is compressing the seal protector
Seal protector feels loose and/or comes off the output seal during install.	<ul style="list-style-type: none">● Ensure that Seal protector is completely flush with the output seal● After installing Seal protector, tuck the handle behind harnesses for additional retention if needed
Seal protector breaks due to repeated use	<ul style="list-style-type: none">● Replace with another Seal protector tool





CAUTION

Risk of

- damage to vehicle or property



CAUTION

Risk of Pinch Point

REV	DATE	CHANGE DESCRIPTION
1	02/11/2026	Initial release

